



LEARN MORE AT

cityonahillmke.org



FOR RENT

CITY ON A HILL INC.

2224 W. Kilbourn Ave, Milwaukee, WI 53233

2 OFFICE SPACES (RENTED TOGETHER OR SEPARATELY)

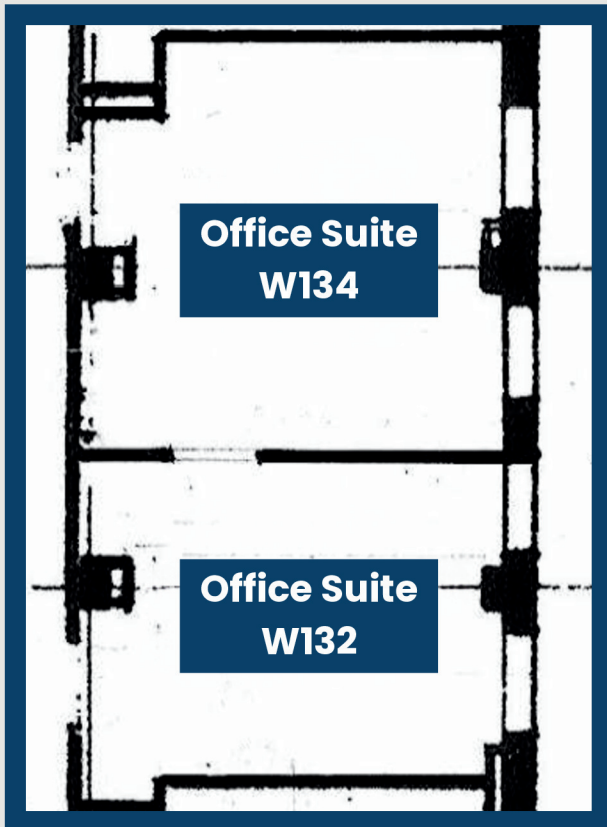

DESCRIPTION

Office W132 is 181 square foot and Office W134 is 224 square foot. Our building location is minutes away from Marquette University and downtown Milwaukee.

MORE FEATURES

- W132 has a sink and is carpeted
- W134 has VCT flooring
- Free off-street parking
- Handicap accessible
- Electricity and heat included
- Secured facility

(414)-931-6670 | LEASING@CITYONAHILLMKE.ORG